

## Arrangement of the Rumah Lontiok Area as a Living Monument for Malay Traditional Architecture Tourism in Kampar Regency

Muhd. Arief Al Husaini<sup>1\*</sup>, Wahyu Hidayat<sup>2</sup>, Mashuri<sup>3</sup>, Sri Djuniati<sup>4</sup>, Asyrul Fikri<sup>5</sup>, Nurul Mustaqimmah<sup>6</sup>

<sup>1,2,3</sup>Jurusan Arsitektur, Fakultas Teknik, Universitas Riau

<sup>4</sup>Jurusan Sipil, Fakultas Teknik, Universitas Riau

<sup>5</sup>Jurusan Pendidikan Sejarah, FKIP, Universitas Riau

<sup>6</sup>Jurusan Ilmu Komunikasi, FISIP, Universitas Riau

**Corresponding Author:** Muhd. Arief Al Husaini [muhd.arief@lecturer.unri.ac.id](mailto:muhd.arief@lecturer.unri.ac.id)

### ARTICLE INFO

*Keywords:* Rumah Lontiok, Heritage, Conservation, Tourism

*Received :* 25 September

*Revised :* 08 October

*Accepted:* 10 November

©2024 Husaini, Hidayat, Mashuri, Djuaniati, Fikri, Mustaqimmah: This is an open-access article distributed under the terms of the [Creative Commons Attribution 4.0 International](https://creativecommons.org/licenses/by/4.0/).



### ABSTRACT

Rumah Lontiok is a traditional Malay house in Kampar Regency. One of the Rumah Lontioks that exists as residences and tourist attractions is the Rumah Lontiok in Kampung Pulau Belimbing which is a hundred years old. However, currently, there is damage in the spatial layout of the Rumah Lontiok area which is characterized by not placing the building according to its original condition. This will eliminate the value of the cultural significance of the Rumah Lontiok area. The purpose of this writing is to obtain a conservation plan for the arrangement of the Rumah Lontiok area. The method used is qualitative descriptive. The author conducted an interview, excavated historical information, and observed the state of the Rumah Lontiok area. The results obtained are the concept of adaptive use in area conservation by restoring buildings to their original state and adding tourist facilities to support cultural tourism activities in the Rumah Lontiok area.

## **INTRODUCTION**

Cultural heritage sites can be eroded and lost by the times not only due to physical factors such as age and natural factors such as earthquakes, but also by social factors, community habits, culture, and economic factors because conservation efforts are considered better than rebuilding cultural heritage buildings because there are aspects of authenticity that are maintained in the cultural heritage sites themselves (Unesco, 1991). Meanwhile, efforts to preserve cultural heritage areas are the entire process of conservation, interpretation, and management of an area so that the cultural meaning contained can be well preserved. In the preservation of cultural heritage areas, it is necessary to provide opportunities for people who are culturally responsible for the area to participate in the preservation process. Conservation itself means efforts to preserve or protect. Conservation comes from the English language, conservation which means preservation or protection (Burra, 1992).

Kampar Regency as one of the districts in Riau Province has a cultural heritage in the form of Rumah Lontiok which is one of the Malay traditional houses of Riau Province which has the potential to be included in the cultural heritage heritage. Efforts to preserve cultural heritage objects require the involvement of many parties and the most important thing is the involvement of the community, especially in cultural heritage objects that are still inhabited (living monuments). The preservation of living monuments is sometimes more difficult, due to the owner's lack of understanding of the importance of preserving his cultural heritage objects.

The Rumah Lontiok that will be conserved is the Rumah Lontiok in Kuok Village, especially which is managed by the Golden Candlestick Foundation. Rumah Lontiok is still used as a residence so making this conservation effort will be slightly different from the conservation of retired buildings, but this is also an added value for tourism value because residential activities of traditional communities can be an added value to Rumah Lontiok tourism. The condition of houses that have begun to deteriorate needs to be maintained (Husaini, 2023).

Currently, the condition of the area is experiencing structural damage and spatial patterns that do not follow past conditions. This ambiguity is described in buildings that have moved and the circulation of the area that does not have a movement orientation in the area. The area that is currently functioning as a tourist area, is not equipped with tourist support facilities so visitors do not feel comfortable, and cultural tourism performance activities cannot be accommodated. So it is necessary to take action to arrange the area to suit the original conditions and add tourist support facilities. Conservation actions for the establishment of regional sites can consider clear zoning and circulation as cultural heritage areas.

## **LITERATURE REVIEW**

The Lontiok traditional house in Belimbing Island Village, West Bangkinang District, Kampar Regency, Riau Province, is one of the intangible cultural heritages in this province. This village is named "Star Island" because in the past many star fruit trees were growing there. Rumah Lontiok, also known

as the pencalang house or sassy house, is a house on stilts made of wood. The shape is similar to a ship, which in the local language is called pencalang or presumptuous. This traditional house was first established in 1900 and was inaugurated as a traditional house for the people of Kampar Regency in 1988 by the Regent of Kampar, with the presence of the Kampar Tourism Office (Syarkawi, 2022).

Malay architecture is one of the traditional architectural works that is an important asset in the archipelago. It is an essential part of the cultural and heritage wealth that needs to be studied in depth. According to Almudra (2004), technological advancements, education levels, insights, and socio-economic conditions affect the concepts, tastes, and needs of the Malay community for houses, including the form and function of the Malay houses themselves. This traditional architecture has a distinctive cultural identity and is spread throughout Indonesia.

Landscape planning plays an important role as a complex guide that connects various functions within a land, landscape, or ecosystem. An effective planning process is dynamic, mutually supportive, and integrated (Nurisjah & Pramukanto, 2001). The arrangement of tourism facilities is carried out by identifying the potential of tourism facilities as tourist attractions, identifying user preferences for tourism facilities, the glory of developing the concept of structuring. The potential of tourism facilities as tourist attractions is seen from three aspects, namely the physical environment aspect, socio-cultural aspect, and economic aspect. (Safira M. A., Wara I. R., Kartika E. S., 2020).

Architectural conservation is an effort to preserve architectural and urban planning objects or buildings from the past inherited by the founders of the city or local communities. This step aims to appreciate the stories of the historical journey told through the architecture (Rukayah & Malik 2012). Conservation is always related to old buildings that have lost their lives. The types of preservation that can be done on old buildings include (Antariksa, 2012):

1. Preservation is a conservation effort that aims to maintain the original shape of the building, the integrity of the materials, and the plant elements that exist on the site. The term is similar to conservation, but it focuses more on simple maintenance without special intervention.
2. Rehabilitation/Renovation is an effort to make old buildings functional again. This is done with improvements tailored to current needs while preserving important elements in terms of architecture, history, and culture. Rehabilitation is usually carried out on buildings that have suffered minor damage.
3. Conservation is the act of maintaining and protecting valuable objects from unnecessary damage or changes. Conservation efforts can be in the form of cleaning, maintenance, and repair.
4. Reconstruction is the process of rebuilding a building with details that match its original shape. This is done on buildings that have been destroyed, to re-display a specific historical period. The material used is a new material that is adapted to the original.

## METHODOLOGY

The method used is qualitative descriptive, that is, the researcher is placed as a key instrument by combining data in the field by conducting inductive analysis (Sugiono, 2010). The object of the research used is the Rumah Lontiok Area in Pulau Belimbing 1 Village, Kuok District, Kampar Regency, Riau. Data collection was carried out through interviews with community leaders and field observations. The equipment used is such as drones and measuring instruments. The informants who provided information during the interview were Mr. Syarkawi the manager of the Rumah Lontiok area and Mr. Khalil an artist who observes the culture of Kuok Village. The interview was conducted in a structured and in-depth manner.







## RESEARCH RESULT



Rumah Lontiok buildings are spread across various areas of Kampar Regency such as Kuok, Bangkinang, Air Tiris, Salo, Kampar, and Rumbio. Rumah Lontioks generally have a large yard. The area of Rumah Lontiok not only reflects traditional aesthetics but also contains important ecological and socio-cultural functions. The components of the Rumah Lontiok area are found in *Kula* (water pond), *Ghangkiang* (rice barn), sugarcane mill for Oluo production, and plant barriers. Rumah Lontioks are usually surrounded by a large yard that is used to grow various types of plants, both those that have aesthetic, food, and medicinal functions.

The layout of the yard and plants is often arranged based on certain principles that reflect the cosmological views of the Malay tribes, where the balance between humans, nature, and spirituality is highly concerned. The open area around the house is often used for various family or community activities, such as traditional celebrations, children's games, or farming activities. *Ghangkiang* is considered a symbol of food security and the economy, this barn is located on the right or left side of the yard, this is done to make it easier to dry food or rice in the yard. In addition, the water reservoir is also located on the right side of the stairs to the house, in ancient times the need for water and utilities was taken directly from the river considering the condition of the river that was still clean, so that the water tank functioned as a water storage place.

Rumah Lontioks are built on poles, providing an open space under the house that is often used for various purposes such as storage of agricultural tools, shelter, or even as a residence for livestock. The area around Rumah Lontiok is often equipped with a simple drainage system to manage rainwater and prevent soil erosion.

Table 1. Existing Condition of the Rumah Lontiok Area

Component	Description	Image
<i>Ghangkiang</i>	Rumah Lontiok has a Ghangkiang that is used to store agricultural products to keep them safe from pests and bad weather. Ghangkiang can reflect the social status of the family as a symbol of well-being and prosperity. The current condition of Ghangkiang's position is not in its original place and has begun to deteriorate.	 
<i>Kula</i>	Kula functions as a water reservoir that functions to store clean water from rain or water taken from the river. This water pool is placed next to the stairs to wash your feet and perform ablution as a symbol of self-purification entering the house. In addition, it also functions for daily needs such as cooking, washing, and watering plants. The current condition of the water tank is not functioning because it is dirty and leaking.	 
<i>Sugarcane Milling</i>	The sugarcane grinder at Rumah Lontiok is used to squeeze sugarcane juice, which is then processed into brown sugar or traditional drinks. This tool functions for the production of sugar and beverages, provides an additional source of income for the family, and meets household needs. In addition, sugarcane milling is part of the local cultural tradition.	 

<p><i>Toilet</i></p>	<p>In the past, Rumah Lontiok did not have a toilet because generally, people used the river. However, currently, as a tourist attraction, toilets are needed as a supporting facility for visitors. The current condition of the toilet is severely damaged so it needs to be repaired to the toilet building.</p>	
<p><i>Fence</i></p>	<p>In the past, the Rumah Lontiok did not have a fence. Owners use plants as a boundary of the area. However, to maintain preservation, a fence is needed so that the Rumah Lontiok is not disturbed by animals and limits visitors. The current condition of the fence is made of iron wire so it is dangerous for visitors.</p>	

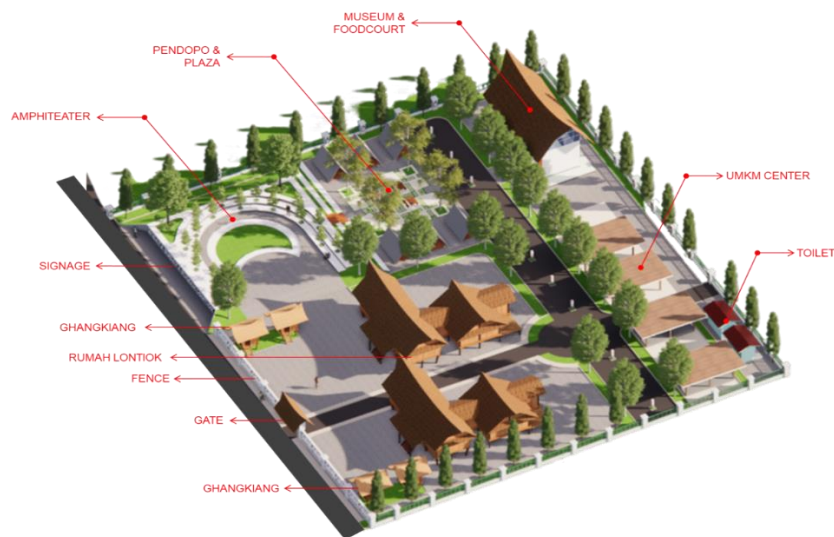

Figure 1. Modeling of the Conservation Action Plan for the Arrangement of the Rumah Lontiok Area

The concept of conservation action for the arrangement of Rumah Lontiok is adaptive reuse, which is a way to protect and maintain historical buildings, especially cultural aspects, with steps to continue to function as a living monument that is actively used by the owner as a residence. This concept is in line with the preservation of buildings and improving the community's

economy due to the additional function of tourism. The design principle in this concept maintains the significance of the building and spatial layout of the Rumah Lontiok area by returning to its original position so that the important value is maintained, the second level of change with the existence of a new additional function as a tourist attraction by adjusting tourist facilities in limited spaces so that it does not change the significance value of the place/building, the third is reversible, namely being able to communicate with the past where visitors can feel the state of the past so that visitors' knowledge increases about the Rumah Lontiok area.

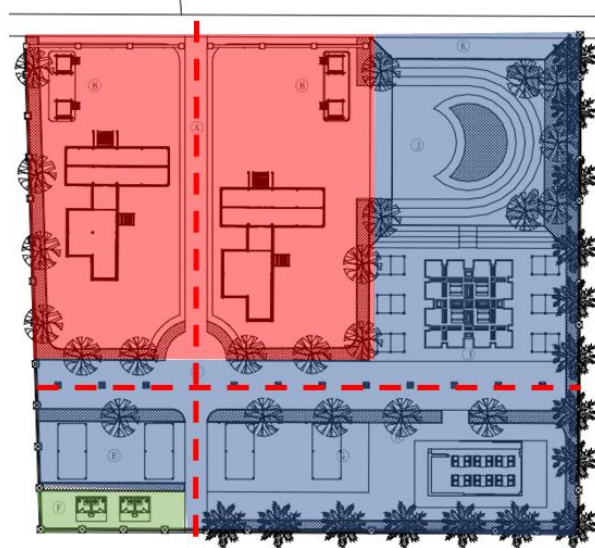

Figure 2. Structural Design and Circulation

The conservation design of the Rumah Lontiok area by dividing the zoning as follows:

1. Core Zone

The red core zone is a building zone of an object suspected of being a cultural heritage, namely the Rumah Lontiok which is old, so it needs a little intervention so as not to change the significance value of the building and place. This is an area that is restricted from changing by reverting to its original state.

2. Supporting Zone

The blue supporting zone is a tourist zone as a tourist area that can be intervened to support the cultural tourism function of Rumah Lontiok. This zone is designed for the placement of tourism support facilities such as museums, sugarcane mills, MSME Centers, Plazas, and Food courts.

3. Supporting Zone

The green supporting zone functions as a supporting area by placing service facilities such as toilets.

4. Circulation

The dotted red striped circulation is made linearly to form a spatial structure, the circulation is made wide with the concept of a boulevard that facilitates the movement of visitors.

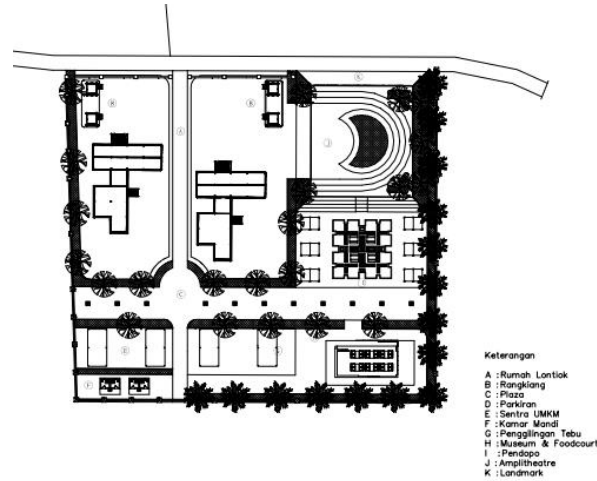





Figure 3. Structural and Circulation Design Siteplan

Table 2. Design of Conservation Facilities for the Lontiok House Area

No	Facility Description	Visualization
1	<p>Fence and Parking Area</p> <p>The area uses a fence to maintain the security of the construction of the Rumah Lontiok and museum objects from animals and theft. The design of the fence applies local carvings with lagam taken from Rumah Lontiok. Parking is provided on the front side of the area to make it easier for visitors to reach the Rumah Lontiok area.</p>	
2	<p>Ghangkiang, Sugarcane Mill, and Kula</p> <p>This design applies core zoning by returning to its original form. This is to strengthen the value of past significance.</p>	
3	<p>Amphitheater &amp; Story Display</p> <p>In the area, an amphitheater is provided as a public space for cultural arts activities for local performances and festivals. At the back of the amphitheater, a local history display room and an explanation of the construction of the Rumah Lontiok are provided. The yard was intervened to cover the floor in the form of paving to</p>	

	facilitate cultural festival activities at Rumah Lontiok.	
4	<p>UMKM Center</p> <p>The area is provided with kiosk facilities that function as an MSME center that sells local products from the community.</p>	
5	<p>Pavilion and Plaza</p> <p>This pavilion functions as a public space to carry out various kinds of community activities and as a leisure space for visitors.</p>	
6	<p>Museum dan Foodcourt</p> <p>The Rumah Lontiok Museum and Foodcourt are placed adjacent to the pavilion so that it becomes a unified public space. This design concept is a Neo Vernacular concept from the Rumah Lontiok to get the unity of the design of the entire area.</p>	

## CONCLUSIONS AND RECOMMENDATIONS

Rumah Lontiok has socio-cultural values that are implemented in the form of architecture. This value reflects the high realization of the cultural character of the Malay community, especially in Kampung Pulau Belimbing, Kuok Village. The embodiment of value is not only manifested in the building but also in the Rumah Lontiok area. In the area, some rules govern the layout of Ghangkiang, Kula, Sugarcane Mill, Fence, and yard, and so on. However, over time there have been changes that are feared to lose the character of the regional layout. In addition, it has an additional function as a tourist attraction that needs to be accommodated.

For this reason, it is necessary to carry out preservation with conservation actions in the Rumah Lontiok area in Kampung Pulau Belimbing. The conservation concept carried out is adaptive use by strengthening the significance value of cultural heritage by placing it back as it was so that visitors can increase their knowledge and experience the bond of experience with the situation of the Rumah Lontiok area in the past. In addition, with the function of tourism, it adds facilities that can support tourism activities such as UMKM Centers, Museums, Foodcourts, Plazas, and Amphitheatres. In the spatial arrangement by determining zoning divisions such as the core zone containing the Rumah Lontiok building, the supporting zone for tourist facilities, and the supporting zone.

## ACKNOWLEDGMENT

The author expresses his gratitude to the Institute for Research and Community Service (LPPM) of the University of Riau for funding this community service activity with contract number 1005/UN19.5.1.3/AL.04/2024. The author also thanks the Kendil Kemilau Foundation for supporting information about the Rumah Lontiok area so that this writing activity runs smoothly.

## REFERENCES

- Al Mudra, M.. 2004. *Rumah Melayu: Memangku Adat Menjemput Zaman*. Yogyakarta: Adicita.
- Antariksa. 2012. Dalam makalahnya yang berjudul Pola Pemukiman Tradisional.
- Burra Charter. *Australian`s Methodology for Conserving Cultural Heritage*. 1992.
- Husaini, MA, dkk. Study of Existing Conditions as Preservation Rumah Lontiok of Kandil Kemilau Emas Foundation. *Indonesian Journal of Interdisciplinary Research in Science and Technology*. Vol 1, No 8. 2023.
- Fairuzahira, S; Rukmi, W; Sari, K. 2020. Elemen Pembentuk Permukiman Tradisional Kampung Naga. *Tata Kota dan Daerah*. Vol 12, No 1. 2020.
- Nurisjah S, Pramukanto Q. 2001. *Perencanaan Kawasan Untuk Pelestarian Lanskap Dan Taman Sejarah*. Bogor: Institut Pertanian Bogor, Fakultas Pertanian, Jurusan Budidaya Pertanian, Program Studi Arsitektur Lanskap.
- Rukayah, R. S., & Malik, A. (2012). Between Colonial, Moslem, and PostIndependence Era, Which Layer of Urban Patterns should be Conserved? *Procedia - Social and Behavioral Sciences*, 68, 775-789. <https://doi.org/10.1016/j.sbspro.2012.12.266>
- Syarkawi, 2014. "history of Rumah Lontiok". Results of Personal Interviews; 5 Oktober 2024, University of Riau.
- Unesco. *Draft Convention on the Protection of Underwater Cultural Heritage: A Commentary prepared for UNESCO, Paris, UNESCO*. 1999.
- Undang-undang RI no 11 Tahun 2010 tentang Cagar Budaya.
- Undang-undang RI no 10 tahun 2009 tentang wisata.